



COMPLEMENTARY PRODUCT CATALOG

VALID FROM 2022



KONGBERG
AUTOMOTIVE



CONTENTS

OUR BUSINESS

- 4 SERVICE AND SUPPORT
- 5 CUSTOMERS' DEMANDS
- 6 BUSINESS AND MISSION

NOTRE BUSINESS

- SERVICE ET SUPPORT
- DEMANDES CLIENTS
- BUSINESS ET MISSION

UNSER UNTERNEHMEN

- KUNDENBETREUUNG UND SERVICE
- KUNDENFORDERUNG
- AUFGABEN UND ZIELE

PRODUCTS

- 12 RAUFOSS KITS
- 18 TOOLS
- 24 PA12 TUBES
- 28 HOSES
- 30 SERVICE COUPLINGS
- 36 AIR BLOW GUNS
- 37 COMPRESSED AIR COILS
AND ACCESSORIES
- 38 CLAMPINGS
- 40 CLASSICAL FITTINGS
- 42 INDEX

PRODUITS

- KITS RAUFOSS
- OUTILLAGE
- TUBES PA12
- TUYAUX
- RACCORDS DE SERVITUDE
- SOUFFLETTES
- SERPENTINS À AIR
ET ACCESSOIRES
- COLLIERS
- RACCORDS CLASSIQUES
- INDEX

PRODUKTE

- RAUFOSS KITS
- WERKZEUGE
- PA12 ROHRE
- SCHLÄUCHE
- SCHNELLKUPPLUNGEN
- DRUCKLUFTPISTOLE
- DRUCKLUFT SPIRALSCHLAUCH
UND ZUBEHÖR
- SCELLEN
- NORMALE VERSCHRAUBUNGEN
- INDEX

A LIFETIME OF SERVICE AND SUPPORT

Global commercial vehicle manufacturers want innovative solutions that prioritize quality and safety.

Kongsberg Automotive's customers include a broad range of leading manufacturers worldwide. To meet individual specifications on concept, design, and technology, vehicle manufacturers prefer close collaboration with Kongsberg Automotive.

We add value to our products by focusing on easy installation, cost-effectiveness, and environment-friendly solutions.



ALIGNED WITH CUSTOMERS' NEEDS



Close follow-up of deliveries is crucial to Kongsberg Automotive's success. Potential deviations are resolved at an early phase or eliminated through product modifications.

We follow up after-market sales via close contact with vehicle manufacturers and dealers, and end-users.

Our manufacturing facilities and sales offices have a global reach, enabling us to optimize production and remain close to our customers.

We provide professional service to our customers within:

- > Sales and logistics
- > Product function training
- > Product installation training
- > Product repair training
- > Warranty handling

Kongsberg Automotive has a global network of distributors to ensure rapid delivery. Visit our website to find a distributor in your country.

OUR BUSINESS

Kongsberg Automotive is a global provider of engineering, design, and a manufacturer for driver and motion control systems, fluid assemblies, and industrial driver interface products.

Our product line includes systems for clutch actuation, cable actuation, gear shifters, transmission control systems, stabilizing rods, couplings, electronic engine controls, specialty hoses, tubes, and fittings.

We specialize in all mobility solutions including automotive, commercial vehicle, and industrial markets.

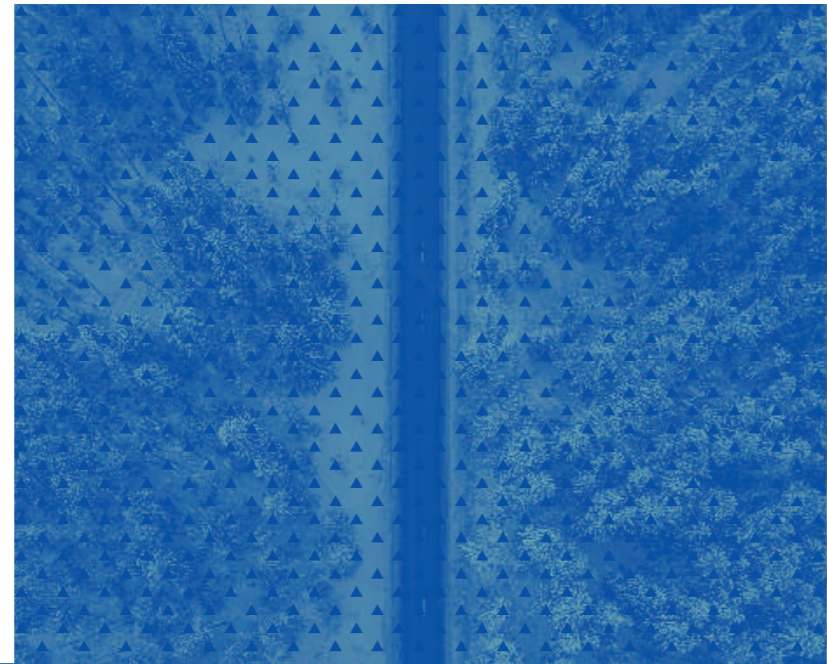
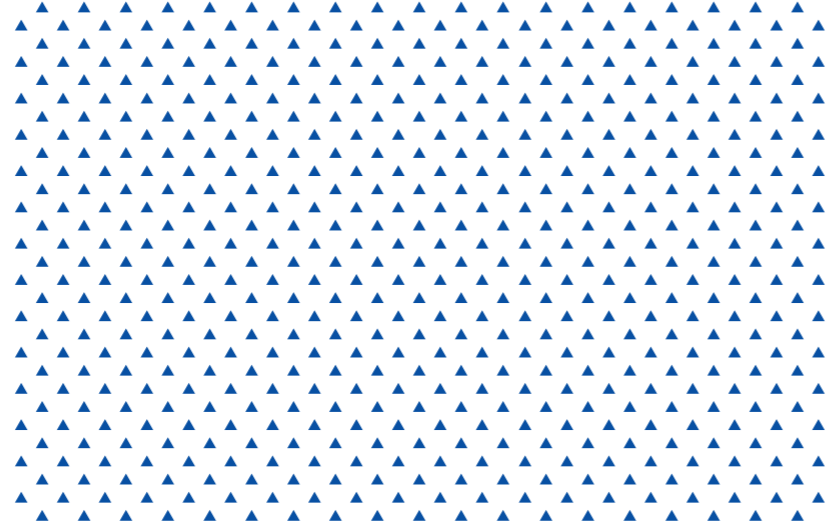

OUR VISION

WE DRIVE THE GLOBAL TRANSITION TO SUSTAINABLE MOBILITY

OUR MISSION

On our path to becoming a true global leader, we put engineering, sustainability, and innovation into practice.

We seek to constantly improve our products, leverage our experience in cutting-edge engineering, and widen our scope to find new solutions and technologies that make mobility safer and cleaner.

Our ambition is to be second to none in all we do. This is how we unlock growth potential and create substantial value for our customers, our employees, and shareholders.

We take responsibility as a strong global team. We are committed to making a difference by developing our skill-set and delivering excellent products.





PRODUCTS

KONGSBERG
AUTOMOTIVE



**RAUFOSS ABC BOX
COFFRET RAUFOSS ABC
RAUFOSS ABC SORTIMENT**

REF.	DESIGNATION	CONTENT			
2600960	Raufoss ABC Couplings box	101 pieces			
REF.	DESIGNATION	QTY	REF.	DESIGNATION	QTY
93150012	ABC Swivel regular M 12x1,5	3	96210012	Push-in Plug T 12x1,5	3
93150014	ABC Swivel regular M 14x1,5	2	90206005	Threadless Push-In regular T 6x1	2
93150016	ABC Swivel regular M 16x1,5	5	90208005	Threadless Push-In regular T 8x1	5
93150022	ABC Swivel regular M 22x1,5	3	90212005	Threadless Push-In regular T 12x1,5	5
90106012	Push-in Coupling M 12x1,5 T 6x1	3	90216006	Threadless Push-In heavy duty T 16x2	2
90106016	Push-in Coupling M 16x1,5 T 6x1	3	96150205	ABC Union female regular	5
90108012	Push-in Coupling M 12x1,5 T 8x1	5	92050090	ABC 90° elbow regular	5
90108016	Push-in Coupling M 16x1,5 T 8x1	5	92050010	ABC Union T&L regular	3
90108022	Push-in Coupling M 22x1,5 T 8x1	3	92050030	ABC Union Y regular	2
90112016	Push-in Coupling M 16x1,5 T 12x1,5	5	96150106	ABC Reducer heavy duty -> regular	2
90112022	Push-in Coupling M 22x1,5 T 12x1,5	3	92060090	ABC 90° Elbow heavy duty	2
90116016	Push-in Coupling M 16x1,5 T 16x2	2	92060010	ABC Union T&L heavy duty	1
90116022	Push-in Coupling M 22x1,5 T 16x2	3	93160016	ABC Swivel heavy duty M 16x1,5	2
96452018	Rotolock 18mm	1	93160022	ABC Swivel heavy duty M 22x1,5	2
96450020	Rotolock 20mm	1	96606010	Release tool standard T 6x1	2
96450022	Rotolock 22mm	2	96608010	Release tool standard T 8x1	2
96452028	Rotolock 28mm	2	96612710	Release tool standard T 12x1,5	2
96210008	Push-in Plug T 8x1	3			



**RAUFOSS ABC BOX
COFFRET RAUFOSS ABC
RAUFOSS ABC SORTIMENT**

REF.	DESIGNATION	CONTENT			
2600967	ABC - Building Bloc system regular	53 pieces			
REF.	DESIGNATION	QTY	REF.	DESIGNATION	QTY
93150012	ABC Swivel M 12x1,5 regular	3	90308005	Integral T 8x1 regular	2
93150014	ABC Swivel M 14x1,5 regular	1	90310005	Integral T 10x1 regular	2
93150016	ABC Swivel M 16x1,5 regular	3	90310105	Integral T 10x1,25 regular	2
93150022	ABC Swivel M 22x1,5 regular	3	90312205	Integral T 12x1,5 regular	1
93351622	Swivel bulk regular M 22x1,5 - M 16x1,5	1	92050045	45° elbow regular	2
96450022	Rotolock regular Hex 22mm	2	92050090	90° elbow regular	2
96452028	Rotolock regular Hex 28mm	3	92050015	Union "F" regular	2
90206005	Threadless Push-In regular T 6x1	3	92050010	Union "L + T" regular	2
90208005	Threadless Push-In regular T 8x1	3	92050030	Union "Y" regular	2
90210005	Threadless Push-In regular T 10x1	3	92052060	3-way Bloc regular	2
90210105	Threadless Push-In regular T 10x1,25	2	92050070	Cross regular	2
90212005	Threadless Push-In regular T 12x1,5	2	92050061	4-way bloc regular	1
90306005	Integral T 6x1 regular	2			



SMALL RAUFOSS ABC BOX
COFFRET RAUFOSS ABC PETIT
KLEINES RAUFOSS ABC SORTIMENT

REF.	DESIGNATION	CONTENT			
2600958	Small Raufoss ABC box	61 pieces			
REF.	DESIGNATION	QTY	REF.	DESIGNATION	QTY
90108016	ABC New Line Push-in coupling M16 x 1,5 T 8x1	3	92050010	Union T&L, regular	2
90110116	ABC New Line Push-in coupling M16 x 1,5 T 10x1,25	3	92050045	ABC 45° Elbow, regular	3
90112016	ABC New Line Push-in coupling M16 x 1,5 T 12x1,5	3	92050090	ABC 90° Elbow, regular	3
90115016	ABC New Line Push-in coupling M16 x 1,5 T 15x1,5	3	92060010	Union T&L, heavy duty	3
90208005	Threadless push-in coupling, regular T 8x1	3	92060045	ABC 45° Elbow, heavy duty	2
90210105	Threadless push-in coupling, regular T 10x1,25	2	92060090	ABC 90° Elbow, heavy duty	2
90212005	Threadless push-in coupling, regular T 12x1,5	3	96608010	Release tool standard T 8x1	3
90215006	Threadless push-in coupling, heavy duty T 15x1,5	3	96610010	Release tool standard T 10x1; 10x1,25; 10x1,5 - 3/8"	2
90508008	ABC tube connector T 8x1	3	96612710	Release tool standard T 12x1,5	2
90512012	ABC tube connector T 12x1,5	3	96615010	Release tool standard T 15x1,5	2
93150016	ABC swivel, regular, M16x1,5	3	6237616	Transfer adapter M22x1,5 / M16x1,5	2
93160016	ABC swivel, heavy duty, M16x1,5	3			

SMALL RAUFOSS ABC BOX
COFFRET RAUFOSS ABC PETIT
KLEINES RAUFOSS ABC SORTIMENT

REF.	DESIGNATION	CONTENT			
2600959	Small Raufoss ABC box	63 pieces			
REF.	DESIGNATION	QTY	REF.	DESIGNATION	QTY
6237616	Transfer adapter M22x1,5/ M16x1,5	3	90512012	ABC tube connector T 12x1,5	3
90106016	ABC New Line Push-in coupling M16 x 1,5 T 6x1	3	92050010	Union T&L, regular	3
90108016	ABC New Line Push-in coupling M16 x 1,5 T 8x1	3	92050045	ABC 45° Elbow, regular	3
90110016	ABC New Line Push-in coupling M16 x 1,5 T 10x1	3	92050090	ABC 90° Elbow, regular	3
90112016	ABC New Line Push-in coupling M16 x 1,5 T 12x1,5	3	93150016	ABC swivel, regular, M16x1,5	3
90206005	Threadless push-in coupling, regular T 6x1	4	93150022	ABC swivel, regular, M22x1,5	3
90208005	Threadless push-in coupling, regular T 8x1	4	96606010	Release tool standard T 6x1	2
90210005	Threadless push-in coupling, regular T 10x1	4	96608010	Release tool standard T 8x1	2
90212005	Threadless push-in coupling, regular T 12x1,5	4	96610010	Release tool standard T 10x1; 10x1,25; 10x1,5 - 3/8"	2
90506006	ABC tube connector T 6x1	3	96612710	Release tool standard T 12x1,5	2
90508008	ABC tube connector T 8x1	3			



MULTIBOX RAUFOSS ABC
MULTIBOX RAUFOSS ABC
MULTIBOX RAUFOSS ABC

REF.	DESIGNATION	CONTENT
260106	Multibox Raufoss ABC	275 pieces

REF.	DESIGNATION	QTY
90106016	ABC New Line Push-in coupling M16x1,5 T 6x1	5
90108016	ABC New Line Push-in coupling M16x1,5 T 8x1	5
90108022	ABC New Line Push-in coupling M22x1,5 T 8x1	5
90110016	ABC New Line Push-in coupling M16x1,5 T 10x1	5
90110022	ABC New Line Push-in coupling M22x1,5 T 10x1	5
90112016	ABC New Line Push-in coupling M16x1,5 T 12x1,5	5
90112022	ABC New Line Push-in coupling M22x1,5 T 12x1,5	5
90116016	ABC New Line Push-in coupling M16x1,5 T 16x2	5
90116022	ABC New Line Push-in coupling M22x1,5 T 16x2	5
90206005	ABC Threadless Push-in regular T 6x1	5
90208005	ABC Threadless Push-in regular T 8x1	5
90210005	ABC Threadless Push-in regular T 10x1	5

90212005	ABC Threadless Push-in regular T 12x1,5	5
90306005	ABC Integral T 6x1 regular	5
90308005	ABC Integral T 8x1 regular	5
90310005	ABC Integral T 10x1 regular	5
90312205	ABC Integral T 12x1,5 regular	5
90506006	ABC tube connector T 6x1	5
90508008	ABC tube connector T 8x1	5
90510010	ABC tube connector T 10x1	5
90512012	ABC tube connector T 12x1,5	5
90516016	ABC tube connector T 16x2	5
93150010	ABC Swivel M10x1 regular	5
93150012	ABC Swivel M12x1,5 regular	5
93150014	ABC Swivel M14x1,5 regular	5
93150016	ABC Swivel M16x1,5 regular	5
93150022	ABC Swivel M22x1,5 regular	5
6237887	Bulkhead coupling with o-ring and nut M22x1,5/ M22x1,5	5
6237835	Bulkhead coupling with o-ring and nut M22x1,5/ M16x1,5	5
6237834	Bulkhead coupling with o-ring and nut M16x1,5/ M16x1,5	5
92050045	ABC 45° elbow regular	5
92050015	ABC Union F regular	5
92050090	ABC 90° elbow regular	5
92050010	ABC Union T&L regular	5
6237614	Transfer adapter M16x1,5/ M12x1,5	5
6237616	Transfer adapter M22x1,5/ M16x1,5	5
6237605	Plug M12x1,5	5
6237607	Plug M16x1,5	5
6237608	Plug M22x1,5	5
6238787	Drain plug M22x1,5 with key ring	5
6237776	Test point, ISO 3583 M16x1,5	5
6237777	Test point, ISO 3583 M22x1,5	5
6237999	Bulkhead coupling M22x1,5/ M16x1,5/ M16x1,5	5
6237830	90° elbow for bulkhead witho-ring and nut, M16x1,5/ M16x1,5	5
6237890	90° elbow for bulkhead witho-ring and nut, M22x1,5/ M16x1,5	5
96150205	ABC Union female regular	5
92050030	ABC Union Y regular	5
92052060	ABC 3 way Block regular	5
92050070	ABC 4 way cross regular	5
96050000	ABC threadless test point ISO 3583, regular	5
96606010	Release tool standard T 6x1	5
96608010	Release tool standard T 8x1	5
96610010	Release tool standard T 10x1	5
96612710	Release tool standard T 12x1,5	5
96616010	Release tool standard T 16x2	5



PROFESSIONAL RELEASE TOOLS KIT
ASSORT. OUTILS DÉCONNEXION PRO
PROFI-DEMONTAGE WERKZEUGSKIT

REF.	DESIGNATION	CONTENT
2600970	Professional release tools kit	6 pieces

REF.	DESIGNATION	QTY
96606020	Release Tool Professional Ø 6x1,0 - 1/4"	1
96608020	Release Tool Professional Ø 8x1,0	1
96610020	Release Tool Professional Ø 10x1,0 10x1,25 10x1,5 - 3/8"	1
96612020	Release Tool Professional Ø 12x1,5 - 1/2"	1
96615020	Release Tool Professional Ø 15x1,5	1
96616020	Release Tool Professional Ø 16x2,0 - 5/8"	1

PROFESSIONAL RELEASE TOOLS KIT
ASSORT. OUTILS DÉCONNEXION PRO
PROFI-DEMONTAGE WERKZEUGSKIT

REF.	DESIGNATION	CONTENT
2600971	Professional release tools kit	4 pieces

REF.	DESIGNATION	QTY
96606020	Release tool professional Ø 6x1,0 - 1/4"	1
96608020	Release tool professional Ø 8x1,0	1
96610020	Release tool professional Ø 10x1,0 10x1,25 10x1,5 - 3/8"	1
96612020	Release tool professional Ø 12x1,5 - 1/2"	1



**PROFESSIONAL RELEASE TOOLS KIT
ASSORT. OUTILS DÉCONNEXION PRO
PROFI-DEMONTAGE WERKZEUGSKIT**

REF.	DESIGNATION	CONTENT
2600922	Professional release tools kit	6 pieces

REF.	DESIGNATION	QTY
96606021	Release tool professional Ø 6x1 - 1/4"	1
96608021	Release tool professional Ø 8x1	1
96610021	Release tool professional Ø 10x1 10x1,25 10x1,5 - 3/8"	1
96612021	Release tool professional Ø 12x1,5 - 1/2"	1
96615021	Release tool professional Ø 15x1,5	1
96616021	Release tool professional Ø 16x2 - 5/8"	1

**PROFESSIONAL RELEASE TOOLS KIT
ASSORT. OUTILS DÉCONNEXION PRO
PROFI-DEMONTAGE WERKZEUGSKIT**

REF.	DESIGNATION	CONTENT
2600910	Professional release tools kit	6 pieces

REF.	DESIGNATION	QTY
96606021	Release tool professional Ø 6x1 - 1/4"	1
96608021	Release tool professional Ø 8x1	1
96610021	Release tool professional Ø 10x1 10x1,25 10x1,5 - 3/8"	1
96612021	Release tool professional Ø 12x1,5 - 1/2"	1



ABC DISPLAY KIT
COFFRET DE DÉMONSTRATION ABC
ABC VORFÜHRUNGSKOFFER

REF.	DESIGNATION	CONTENT
194990	ABC display kit	12 pieces

REF.	DESIGNATION	QTY
96615010	Release tool professional	1
90215006	ABC threadless push-in coupling, heavy duty T 15x1,5	1
92060010	ABC Union T&L heavy duty	1
93160016	ABC Swivel heavy duty M 16x1,5	1
96550006	ABC Union male regular -> heavy duty	1
96452018	Rotolock 18mm	1
92050090	ABC 90° Elbow regular	1
90212005	Threadless push-in coupling, regular T 12x1,5	1
96612710	Release tool standard T 12x1,5	1
892000	Circlips pliers 90°	1
194989	Tube 12x1,5 black PA12	0,11m
194988	Tube 15x1,5 Black PA12	0,13m

TOOLS

OUTILLAGES

WERKZEUGE



CIRCLIPS PLIERS
PINCES À CIRCLIPS
SEGERING ZANGE

REF.	DESIGNATION	
892000	90° angled plier for outer circlips	1
892001	Straight plier for outer circlips	1

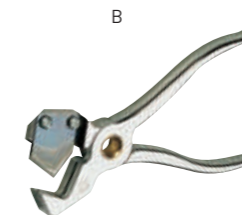
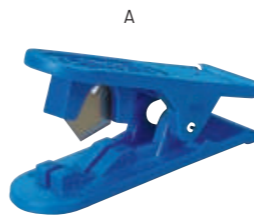

PLIERS TO CUT POLYAMIDE TUBES
PINCES À COUPER LES TUBES POLYAMIDE
POLYAMID ROHR ABSCHNEIDER

REF.	DESIGNATION	
209010(see picture A)	Pocket plier for polyamide	1
209013(see picture B)	Workshop clamp for polyamide	1
209028	Spare blade for 209013	1

TUBES PA12 DIN 74324/DIN73378

TUBES PA12 DIN 74324/DIN73378

PA12 ROHRE DIN 74324/DIN73378

POLYAMIDE 12 TUBES - (UV RESISTANT) DIN 74324/DIN73378 for metrcal dimensions.

To complete our range of pneumatic fittings, here are all the tubes you need: Polyamide 12 has a good resistance to chemicals. Under normal use conditions, it can withstand bases, alcohols, ethers, hydrocarbons, oils, gasolines, diesel fuel, detergents, fresh or salt water, etc.

These tubes can be used in a wide temperature range, are compatible with many fluids, and have lots of benefits:

- lightness
- excellent resistance to dampness
- no corrosion
- very low friction coefficient
- good dimensional stability

Operating temperature: - 40° C to 100° C (Max + 105° C)

Color: black - temperature and light stabilized- certified for brakes.

TUBES POLYAMIDE 12 - (RÉSISTANT AUX ULTRAVIOLETS) Normalisés DIN 74324/DIN73378 pour les cotes métriques.

Pour compléter notre gamme de raccords pneumatiques, tous les tubes dont vous avez besoin: Le polyamide 12 possède une bonne résistance aux produits chimiques. Dans des conditions normales d'utilisation, il résiste aux bases, alcools, éthers, hydrocarbures, lubrifiants, essences, gazole, détergents, eau douce ou salée, etc.

Utilisables dans une large plage de températures et compatibles avec de nombreux fluides, les tubes en polyamide 12 apportent à l'utilisateur d'importants avantages:

- légèreté
- excellente tenue à l'humidité
- absence de corrosion
- très faible coefficient de frottement
- bonne stabilité dimensionnelle.

Températures d'utilisation: de - 40° C à 100° C (Maximum + 105° C)

Coloris noir - stabilisé température et lumière homologué freins

POLYAMID 12 ROHRE - (UV-BESTANDIG). DIN 74324/DIN73378 für metrische Anteile.

Um unser Angebot von pneumatischen Verschraubungen zu ergänzen, bieten wir Ihnen die folgenden PA 12-Rohre an: Polyamid 12 hat eine gute Beständigkeit gegen Chemikalien. Bei normalem Gebrauchbedingungen, widersteht es Laugen, Alkohol, Ether, Kohlenwasserstoffe, Öle, Benzin, Dieseldieselkraftstoff, Reinigungsmittel, Süßwasser- oder Salzwasser usw.

Die Rohre sind in einem weiten Temperaturbereich verwendbar und mit vielen Flüssigkeiten vereinbar. Polyamid-Rohre 12 bieten dem Anwender wesentliche Vorteile:

- Leichtigkeit
- ausgezeichnete Beständigkeit gegen Feuchtigkeit
- keine Korrosion
- sehr niedrigen Reibungskoeffizienten
- gute Dimensionsstabilität.

Betriebstemperatur: - 40° C bis 100° C (Max + 105° C)

Farbe: schwarz - Temperatur und Licht stabilisiert - zertifiziert für Bremsen.

Correction factor of pressures according to temperature

Facteur de correction des pressions en fonction de la température

Korrekturfaktor des Drucks je nach Temperatur

- 20° C	0° C	23° C	40° C	60° C	80° C	90° C
1,8	1,4	1,0	0,7	0,5	0,45	0,38



25 METERS ROLLS PINCES À COUPER LES TUBES POLYAMIDE POLYAMID ROHR ABSCHNEIDER

REF.	Ø TUBE	NORM	
583052N	4x1	DIN 74324	25
583001N	6x1	DIN 74324	25
583003N	8x1	DIN 74324	25
583004N	8x1,5	DIN 73378	25
583013N	9x1,5	DIN 74324	25
583005N	10x1	DIN 74324	25
583057N	10x1,25	DIN 74324	25
583008N	10x1,5	DIN 73378	25
583010N	11x1,5	DIN 74324	25
583009N	12x1	DIN 73378	25
583006N	12x1,5	DIN 74324	25
583063N	12x2	DIN 73378	25
583014N	14x2	DIN 74324	25
583007N	15x1,5	DIN 74324	25
583015N	16x2	DIN 74324	25
583011N	18x2	DIN 74324	25

25 METERS CARDBOARD CARTONS DÉROULEURS DE 25 MÈTRES ROLLE 25 METER IN KARTON

REF.	Ø TUBE	NORM	
673052N	Tube 4x1	DIN 74324	25
673001N	Tube 6x1	DIN 74324	25
673003N	Tube 8x1	DIN 74324	25
673013N	Tube 9x1,5	DIN 74324	25
673005N	Tube 10x1	DIN 74324	25
673057N	Tube 10x1,25	DIN 74324	25
673008N	Tube 10x1,5	DIN 73378	25
673010N	Tube 11x1,5	DIN 74324	25
673009N	Tube 12x1	DIN 73378	25
673006N	Tube 12x1,5	DIN 74324	25

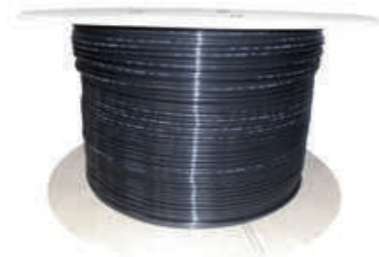

**BENCH GRINDERS
TOURET
ROHRTROMMEL**

REF.	Ø TUBE	NORM	
585001	6x1	DIN 74324	1500
585003	8x1	DIN 74324	1000
586057	10x1,25	DIN 74324	750
586006	12x1,5	DIN 74324	500
586015	16x2	DIN 74324	200

Other requests on demand, please contact us



**100 METERS ROLLS
ROULEAUX DE 100 MÈTRES
100 METER ROLLEN**

REF.	Ø TUBE	NORM	
672052	Tube 4x1	DIN 74324	100
672001	Tube 6x1	DIN 74324	100
672003	Tube 8x1	DIN 74324	100
672005	Tube 10x1	DIN 74324	100
672057	Tube 10x1,25	DIN 74324	100
672008	Tube 10x1,5	DIN 73378	100
672006	Tube 12x1,5	DIN 74324	100
672007	Tube 15x1,5	DIN 74324	100
672015	Tube 16x2	DIN 74324	100
672011	Tube 18x2	DIN 74324	100



**200 METERS ROLLS
ROULEAUX DE 200 MÈTRES
200 METER ROLLEN**

REF.	Ø TUBE	NORM	
672024	Tube 6x1	DIN 74324	200
672025	Tube 8x1	DIN 74324	200
672026	Tube 12x1,5	DIN 74324	200
672027	Tube 15x1,5	DIN 74324	200
672028	Tube 16x2	DIN 74324	200
672029	Tube 18x2	DIN 74324	200



**COLORED TUBES 100 METERS
TUBES COULEUR DE 100 MÈTRES
FARBIGE ROHRE 100 METER**

REF.	Ø TUBE	COLOR	NORM	
672046*	Tube 6x1	Green	DIN 73378	100
672047*	Tube 6x1	Yellow	DIN 73378	100
672048*	Tube 6x1	Blue	DIN 73378	100
672049*	Tube 6x1	Red	DIN 73378	100
672050*	Tube 6x1	Natural	DIN 73378	100
672030	Tube 8x1	Green	DIN 73378	100
672031	Tube 8x1	Yellow	DIN 73378	100
672032	Tube 8x1	Blue	DIN 73378	100
672033	Tube 8x1	Red	DIN 73378	100
672051*	Tube 8x1	Natural	DIN 73378	100
672061*	Tube 12x1,5	Yellow	DIN 73378	100
672063*	Tube 12x1,5	Red	DIN 73378	100

Other requests on demand, please contact us

* Minimum order quantities may be needed on these specific items

HOSES

TUYAUX

SCHLÄUCHE



HOSES TUBES DE GONFLAGE LUFTSCHLAUCH

In black SBR / NR antistatic 100Mohm with textile inner braid reinforcement.
Outer in NBR/PVC blue
Temperature: -20°C to +80°C

REF.	OUTER Ø IN MM	INNER Ø IN MM	PRESSURE IN BARS	LIMIT PRESSURE OF NO-BREAK	BENDING RADIUS IN MM	
680100	13	6	20	60	35	20
680102	15	8	20	60	45	20



HOSES DIN 74310 - UTAC ST 954-2 TUBES DIN 74310 - UTAC ST 954-2 LUFTSCHLAUCH DIN 74310 - UTAC ST 954-2

REF.	OUTER Ø IN MM	INNER Ø IN MM	PRESSURE IN BARS	TEMPERATURE	LIMIT PRESSURE OF NO-BREAK	BENDING RADIUS IN MM	
680010 (UTAC ST 954-2)	18	10	20	-40°C to 70°C	65	80	50
680014 (DIN 74310)	18	11	10	-40°C to 70°C	60	70	40
680011 (DIN 74310)	25	13	10	-40°C to 70°C	60	100	20

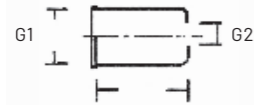

CRIMP SOCKET FOR HOSE 680010 DOUILLE DE SERTISSAGE POUR TUBE 680010 PRESSHÜLSE FÜR SCHLAUCH 680010

REF.	Ø G1	Ø G2	L	
204050	19,5	14	32	10



END FITTINGS FOR BRAKE HOSES EMBOUTS POUR FLEXIBLE DE FREIN SCHLAUCHSTUTZEN

REF.	DESIGNATION	G1	G2	
203998	Ball coupling with nut	10 x 18	M 18 x 1,5 cône 24° OU 60°	5



SERVICE COUPLINGS

RACCORDS DE SERVITUDE

SCHNELLKUPPLUNGEN

PRESSURE

- Maximum 15 Bars

TEMPERATURE

- Minimum -18°C
- Maximum +70°C

THREAD

- Conical, according to ISO 7.1, BS 21, DIN 2999
- Cylindrical, according to ISO-228 Class A
- Metrical, according to ISO-R/262

TUBES TO USE

- Made of plastic: polyamide 6/11/12, polyethylene, polyurethane, etc...

FLUIDS

- For compressed air

SEAL

The particular shape of the lip seal guarantees a perfect seal on the tube in pressure and in depression. All conical or cylindrical threads are equipped with a sealing device.

HEXAGONAL INTERIOR

All cylindrical or conical threaded straight couplings have also a hexagonal form inside which allows to screw the piece in a reduced space.

PRESSION

- Maximum 15 Bars

TEMPÉRATURE

- Minimum -18°C
- Maximum +70°C

THREAD

- Gaz conique selon ISO 7.1, BS 21, DIN 2999
- Gaz cylindrique selon ISO-228 classe A
- Métrique selon ISO-R/262

TUBES À UTILISER

- En matière plastique: polyamide 6 - 11 - 12, polyéthylène, polyuréthane, etc...

FLUIDES

- Pour air comprimé

ÉTANCHÉITÉ

La forme particulière du joint à lèvres garantit une parfaite étanchéité sur le tube en pression et dépression. Tous les filetages coniques ou cylindriques sont munis d'un dispositif d'étanchéité.

SIX PANS INTÉRIEURS

Tous les raccords droits à filetage cylindrique ou conique disposent également d'un six pans intérieur rendant possible leur vissage dans un espace réduit.

DRUCK

- Maximum 15 Bars

TEMPERATUR

- Minimum -18°C
- Maximum +70°C

GEWINDE

- Konisches Gewinde, gemäß ISO 7.1, BS 21, DIN 2999
- Zylindrisch G, gemäß ISO-228 Klasse A
- Metrisch, gemäß ISO-R/262

ROHRE ZU VERWENDEN

- aus Kunststoff Polyamid 6 - 11 - 12, Polyethylen, Polyurethan, etc...

FLÜSSIGKEITEN

- Für Druckluft

DICHTIGKEIT

Die besondere Form der Lippendichtung garantiert eine perfekte Abdichtung auf dem Schlauch bei Druck wie bei Unterdruck. Alle konischen oder zylindrischen Gewinde sind mit einem Dichtungsverschluss ausgestattet.

INNENSECHSKANT

Alle gerade Stutzen mit zylindrischen oder konischen Gewinden verfügen außerdem über ein sechseckiges Innere, das ermöglicht, den Teil in einem engen Raum zu schrauben.



CYLINDRICAL PUSH-IN COUPLING WITH O-RING UNION MÂLE CYLINDRIQUE AVEC JOINT ZYLINDRISCHE STECKVERBINDUNGEN MIT O-RING

REF.	Ø TUBE	G1	📦
2450019	4	G1/8"	10
2450029	4	G1/4"	10
2450049	6	G1/8"	10
2450059	6	G1/4"	10
2450079	8	G1/8"	10
2450089	8	G1/4"	10
2450099	8	G3/8"	10
2450129	10	G1/4"	10
2450139	10	G3/8"	10
2450179	12	G1/2"	10
2450159	12	G1/4"	10

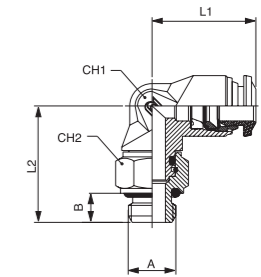

MALE CYLINDRICAL ELBOW ADAPTOR WITH O-RING COUDE MÂLE CYLINDRIQUE ORIENTABLE AVEC JOINTV ZYLINDRISCHE SCHWENKWINKEL MIT O-RING

REF.	Ø TUBE	A	📦
245650	4	G1/8"	10
245660	4	M5	10
245662	5	G1/8"	10
245651	6	G1/8"	10
245652	6	G1/4"	10
245653	8	G1/8"	10
245654	8	G1/4"	10
245664	8	G1/2"	10
245656	10	G1/4"	10
245665	10	G1/2"	10
245658	12	G3/8"	10

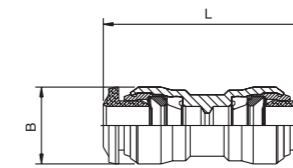

TUBE CONNECTOR UNION DOUBLE ROHRVERBINDER

REF.	Ø TUBE	📦
245308	4	10
245309	5	10
245310	6	10
245311	8	10
245312	10	10
245313	12	10
245314	6 - 4	10
245315	8 - 6	10

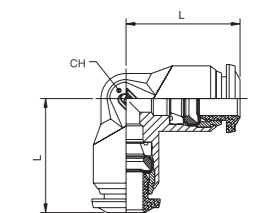

ELBOW EQUAL COUDE ÉGAL GLEICHMÄSSIGER WINKEL

REF.	Ø TUBE	📦
245318	4	10
245320	6	10
245321	8	10
245322	10	10
245323	12	10

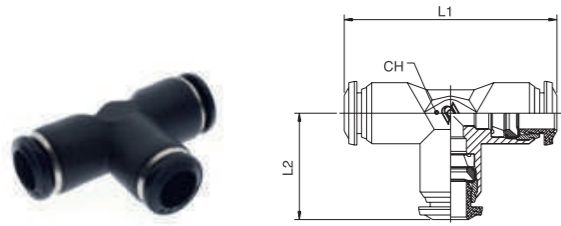

EQUAL T-COUPLING
TÉ ÉGAL
GLEICHMÄSSIGES T-STÜCK

REF.	Ø TUBE	
245328	4	10
245329	5	10
245330	6	10
245331	8	10
245332	10	10
245333	12	10



EQUAL Y-COUPLING
Y ÉGAL
GLEICHMÄSSIGES Y-STÜCK

REF.	Ø TUBE	
245408	4	10
245410	6	10
245411	8	10

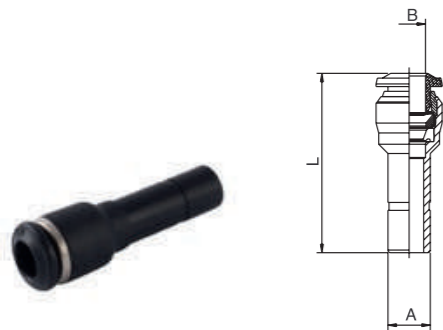

REDUCER
RÉDUCTEUR
REDUZIERSTÜCK

REF.	A	B	Ø	
245951	6	4	6 x 4	10
245955	8	6	8 x 6	10
245958	10	8	10 x 8	10

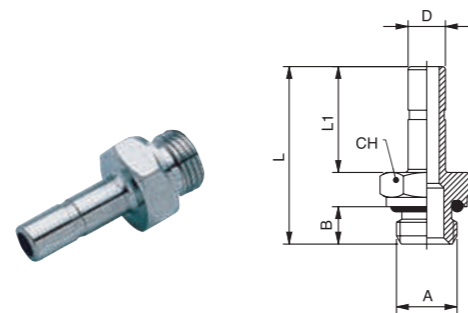

CYLINDRICAL PUSH-IN TRANSFER ADAPTER
ADAPTATEUR MÂLE GAZ CYLINDRIQUE
SCHLAUCHSTUTZEN

REF.	D	A	
244910	6	G1/8"	10
244916	5	G1/4"	10
244918	4	G1/8"	10
244920	6	G1/4"	10
244921	8	G1/4"	10
244940	8	G1/8"	10



QUICK RELEASE COUPLINGS FOR SERVITUDES
RACCORDS RAPIDES POUR SERVITUDES
STECKVERBINDER SORTIMENT

REF. 245998

CONTENT (68 PIECES)

REF.	DIMENSION	QTY	REF.	DIMENSION	QTY
245308	Tube Connector Ø 4	6	245320	Elbow equal Ø 6	3
245310	Tube Connector Ø 6	10	245321	Elbow equal Ø 8	5
245311	Tube Connector Ø 8	10	245951	Reducer Ø 6 - Ø 4	4
245312	Tube Connector Ø 10	5	245955	Reducer Ø 8 - Ø 6	4
245313	Tube Connector Ø 12	5	244910	Transfer adapter Ø 6-1/8"	2
245328	Equal T Coupling Ø 4	2	244920	Transfer adapter Ø 6-1/4"	2
245330	Equal T Coupling Ø 6	3	244940	Transfer adapter Ø 8-1/8"	2
245331	Equal T Coupling Ø 8	3	244921	Transfer adapter Ø 8-1/4"	2

AIR BLOW GUNS

SOUFFLETTES

DRUCKLUFTPISTOLE



KITS TO CONNECT TO IVECO TEST POINT
KITS À RACCORDER SUR PRISE DE PRESSION IVECO
AUSBLASESETS FÜR IVECO PRÜFANSCHLUSS

REF.	LENGTH	COLOR	
678000B	4 m	Blue	1



KITS TO CONNECT TO MERCEDES TEST POINT
KITS À RACCORDER SUR PRISE DE PRESSION MERCEDES
AUSBLASESETS FÜR MERCEDES PRÜFANSCHLUSS

REF.	LENGTH	COLOR	
679000B	2,80 m	Blue	1



KITS TO CONNECT TO RVI T TYPE
KITS À RACCORDER SUR RVI TYPE T
AUSBLASESETS FÜR T MODELL

REF.	LENGTH	COLOR	
679002B	2,80 m	Blue	1



UNIVERSAL KITS WITH COUPLING DEVICES
KITS UNIVERSELS AVEC COUPLEURS
AUSBLASESETS STANDARD

- Length of 8 m or 3,6 m
- Delivered with the necessary connection (T6).
- Equipped with couplers.
- This kit is the most complete of the range.

REF.	LENGTH	COLOR	
678050B	8,00 m	Blue	1
678050MB	3,60 m	Blue	1



KITS TO CONNECT TO RVI TEST POINT
KITS À RACCORDER SUR PRISE DE PRESSION RVI
AUSBLASESETS FÜR RVI PRÜFANSCHLUSS

REF.	LENGTH	COLOR	
679001	2,80 m	Red	1
679001B	2,80 m	Blue	1



KITS TO CONNECT TO SCANIA TEST POINT
KITS À RACCORDER SUR PRISE DE PRESSION SCANIA
AUSBLASESETS FÜR SCANIA PRÜFANSCHLUSS

REF.	LENGTH	COLOR	
677000B	2,80 m	Blue	1

COMPRESSED AIR COILS AND ACCESSORIES

SERPENTINS À AIR ET ACCESSOIRES

DRUCKLUFT SPIRALSCHLAUCH UND ZUBEHÖR



COMPRESSED AIR COILS DIN 74323 SERPENTINS À AIR COMPRIMÉ DIN 74323 DRUCKLUFT SPIRALSCHLÄUCHE DIN 74323

REF.	COLOR	NUMBER OF TURNS	DESIGNATION	
674251	red	16	1 fixed male side M 16x1,5 / 1 turning nut side M 18x1,5 cone 24° T12	1
674252	yellow	16	1 fixed male side M 16x1,5 / 1 turning nut side M 18x1,5 cone 24° T12	1
674231	red	16	1 fixed male side M16x1,5 / 1 fixed male side M16x1,5	1
674232	yellow	16	1 fixed male side M16x1,5 / 1 fixed male side M16x1,5	1
674233	yellow	16	1 fixed male side M22x1,5 / 1 fixed male side M22x1,5	1
674234	red	16	1 fixed male side M22x1,5 / 1 fixed male side M22x1,5	1
674201	red	19	1 fixed male side M 16x1,5 / 1 turning nut side M 18x1,5 cone 24° T12	1
674202	yellow	19	1 fixed male side M 16x1,5 / 1 turning nut side M 18x1,5 cone 24° T12	1
674203	black	19	1 fixed male side M 16x1,5 / 1 turning nut side M 18x1,5 cone 24° T12	1
674221	red	19	1 fixed male bulkhead coupling side M 18x1,5 cone 24° T12 / 1 fixed male side M 16x1,5	1
674222	yellow	19	1 fixed male bulkhead coupling side M 18x1,5 cone 24° T12 / 1 fixed male side M 16x1,5	1
674223	black	19	1 fixed male bulkhead coupling side M 18x1,5 cone 24° T12 / 1 fixed male side M 16x1,5	1
674083	black	32	1 fixed male side M16x1,5 / 1 turning nut side M18x1,5 cone 24° T12	1

SPECIAL COMPRESSED AIR COILS DIN 74323 SERPENTINS À AIR COMPRIMÉS SPÉCIAUX DIN 74323 SPEZIELLE DRUCKLUFT SPIRALSCHLÄUCHE DIN 74323

REF.	COLOR	NUMBER OF TURNS	DESIGNATION	
674230	black	16	1 fixed male side M16x1,5 / 1 polyamide tube 12x1,5 side	1

ADAPTERS FOR COMPRESSED AIR COILS ADAPTATEURS POUR SERPENTINS À AIR COMPRIMÉ ADAPTER FÜR DRUCKLUFT SPIRALSCHLAUCH

REF.	DESIGNATION	THREAD	
820304*	Nipple (A)	M 18x1,5 cone 24° T12 / M 16x1,5 flat-bottom	5
820704*	Nipple with seal (A)	M 18x1,5 cone 24° T12 / M 16x1,5 flat-bottom	5
810604	Straight bulkhead coupling (B)	M 18x1,5 cone 24° T12 Special Iveco-Man-Scania	5

* Replaced by 6237785: refer to our Raufoss Couplings catalog



COUPLING HEAD TÊTES D'ACCOUPEMENTS KUPPLUNGSKÖPFE

REF.	DESIGNATION	TAPPING	
674207	Trailer side without test point (yellow)	M 16 x 150	1
674206	Trailer side without test point (red)	M 16 x 150	1
674217	Tractor side without test point (yellow)	M 16 x 150	1
674216	Tractor side without test point (red)	M 16 x 150	1

COUPLING HEAD WITH FILTER TÊTE D'ACCOUPEMENT AVEC FILTRE KUPPLUNGSKÖPFE MIT FILTER

REF.	DESIGNATION	TAPPING	
674220	Trailer side with filter (yellow)	M 16 x 150	1
674219	Trailer side with filter (red)	M 16 x 150	1

COUPLING HEAD WITH FILTER AND TEST POINT TÊTE D'ACCOUPEMENT AVEC FILTRE ET PRISE DE PRESSION KUPPLUNGSKÖPFE MIT FILTER UND PRÜFANSCHLUSS

REF.	DESIGNATION	TAPPING	
674208	Trailer side with filter and test point (yellow)	M 16 x 150	1

SEALS FOR TRAILER SIDE HOSE COUPLINGS JOINTS POUR TÊTE D'ACCOUPEMENT DICHTUNGEN FÜR KUPPLUNGSKÖPFE (ANHÄNGER SEITE)

REF.	DESIGNATION	
674213	Seal for head without filter (see picture A)	20
674214	Seal for head with filter (see picture B)	20

OPERATING HANDLES POIGNÉES DE MANŒUVRE HANDGRIFFE FÜR KUPPLUNGSKÖPFE

REF.	TAPPING	
674215	Delivered in kit of 2 (1 red + 1 yellow)	1

CLAMPINGS

COLLIERS

SCHELLEN



METALIC CLAMPS

COLLIERS DE SERRAGE MÉTALLIQUES À VIS SANS FIN

SCHLAUSCHSCHELLE METAL

- One piece housing without any welding nor riveting, blue painted
- full band with raised edges in steel «Aluzink»
- profile rack designed to withstand vibrations and high screw torques.

- carter embouti d'une pièce sans soudure ni rivetage, laqué Bleu
- bande pleine à bords relevés en acier "Aluzink"
- profil de crémaillère conçu pour résister aux vibrations et aux couples de serrage élevés.

- Einteiliges Gehäuse ohne Schweißen weder Nieten, blau lackiert
- Volles Band mit erhöhten Rändern in Stahl «Aluzink»
- Profil-Rack hergestellt um Vibrationen und hohe Drehmoment auszuhalten.

REF.	CLAMPING Ø	WIDTH IN MM	
310520	8 - 12	9	50
310530	10 - 16	9	50
310540	12 - 20	9	50
310542	16 - 25	9	50
310543	20 - 32	9	50
310545	25 - 40	9	50
310546	32 - 50	9	50
310547	40 - 60	9	50
310548	50 - 70	9	50
31056212	16 - 25	12	50
31056312	20 - 32	12	50
31056512	25 - 40	12	50
31056612	32-50	12	50
31056812	40-60	12	50
31056912	50-70	12	50
31057012	60-80	12	50
31057112	70-90	12	50
31057212	80-100	12	50
31057312	90-110	12	50
31057412	100-120	12	50

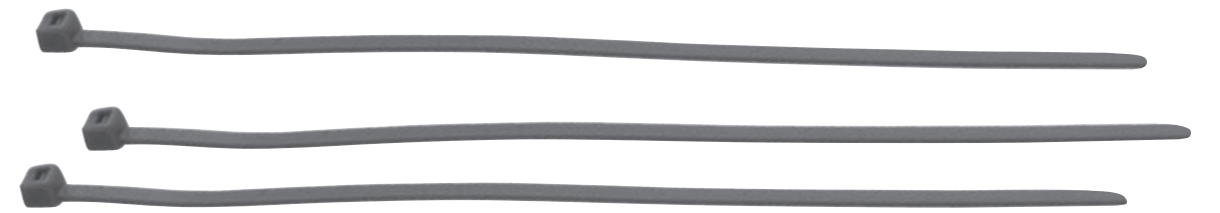

POLYAMIDE 6.6 CABLE TIES

COLLIERS DE SERRAGE EN POLYAMIDE 6.6

KABELBINDER AUS POLYAMID 6.6

- International standard range
- In polyamide 6.6 self-extinguishing Class UL94V-2
 - tensile resistance measured according to specification Mil-S-23190E
 - excellent resistance to hydrocarbons, salts, sludges and diluted acids
 - operating range: from -35° C to +85° C

- Gamme internationale standard
- en polyamide 6.6 auto extinguable classe UL94V-2
 - résistance à la traction mesurée selon la spécification Mil-S-23190E
 - excellente résistance aux hydrocarbures, aux sels, boues et acides dilués
 - plage d'utilisation: de -35° C à +85° C

- Internationale Standard Produktpalette
- Aus Polyamid 6.6 UL94V-2 Klasse
 - Zugfestigkeit gemessen gemäß Spezifikation Mil-S-23190E
 - ausgezeichnete Beständigkeit gegen Kohlenwasserstoffe, Salze, verdünnten Säuren und Schlämmen
 - Verwendungsbereich: von -35° C bis +85° C

REF.	LENGTH IN MM	WIDTH IN MM	MIN. RESISTANCE IN KG	MAX. CLAMPING Ø	COLOR	
311412	98	2,5	8	20	black	100
311413	200	2,6	8	50	black	100
311414	140	3,5	18	32	black	100
311415	200	3,5	18	50	black	100
311416	290	3,5	18	77	black	100
311417	178	4,8	22	47	black	100
311418	290	4,5	22	77	black	50
311419	390	4,8	22	105	black	100
311420	240	7,8	55	65	black	100
311421	300	7,8	55	77	black	100
311422	365	7,5	55	102	black	15
311423	750	7,5	55	220	black	100
311425	180	7,6	55	50	black	100
311426	540	7,5	55	152	black	100
311428	200	4,8	22	50	black	50

CLASSICAL FITTINGS

RACCORDS CLASSIQUES

KLASSISCHE VERBINDER



END FITTINGS WITH WINGNUT FOR TEST CONNECTOR OPENING ISO 3583
EMBOUTS AVEC ÉCROU À OREILLES POUR OUVERTURE PRISE TEST ISO 3583
FLÜGELMUTTER FÜR PRÜFANSCHLÜSSE ISO 3583

REF.	Ø TUBE	TAPPING	
301105	5	M 16 x 1,5	5
301101	6	M 16 x 1,5	5
301102	8	M 16 x 1,5	5

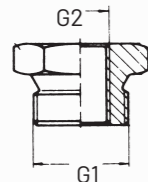

ADAPTERS
ADAPTERS
ADAPTERS

REF.	Ø G1	G2	
821046*	M 22 x 1,5	M 16 x 1,5	5
821050	M 22 x 1,5	G1/2"	5
821049	M 22 x 1,5	G3/8"	5
821048	M 22 x 1,5	G1/4"	5
823520**	M 16 x 1,5	M 22 x 1,5	5
99231**	M 16 x 1,5	M 22 x 1,5	5
999952	M 16 x 1,5	G3/8"	5
999956	G1/2"	M 22 x 1,5	5

* Replaced by 6237616: refer to our Raufoss Couplings catalog
 **Replaced by 6237671: refer to our Raufoss Couplings catalog

PRODUCT INDEX



PART NUMBER	PAGE
99231	40
194990	22
203998	28
204050	28
209010	23
209013	23
209028	23
244910	32
244916	32
244918	32
244920	32
244921	32
244940	32
245308	31
245309	31
245310	31
245311	31
245312	31
245313	31
245314	31
245315	31
245318	31
245320	31
245321	31
245322	31
245328	32
245329	32
245330	32
245331	32
245332	32
245333	32
245408	32
245410	32
245411	32

PART NUMBER	PAGE
245951	32
245955	32
245958	32
245998	33
253323	31
260106	16
301101	40
301102	40
301105	40
310520	38
310530	38
310540	38
310542	38
310543	38
310545	38
310546	38
310547	38
310548	38
311412	39
311413	39
311414	39
311415	39
311416	39
311417	39
311418	39
311419	39
311420	39
311421	39
311422	39
311423	39
311425	39
311426	39
311428	39
585001	26

PART NUMBER	PAGE
585003	26
586006	26
586015	26
586057	26
672001	26
672003	26
672005	26
672006	26
672007	26
672008	26
672011	26
672015	26
672024	26
672025	26
672026	26
672027	26
672028	26
672029	26
672030	27
672031	27
672032	27
672033	27
672046	27
672047	27
672048	27
672049	27
672050	27
672051	27
672052	26
672057	26
672061	27
672063	27
674083	36
674201	36

PART NUMBER	PAGE
674202	36
674203	36
674206	37
674207	37
674208	37
674213	37
674214	37
674215	37
674216	37
674217	37
674219	37
674220	37
674221	36
674222	36
674223	36
674230	36
674231	36
674232	36
674233	36
674234	36
674251	36
674252	36
679001	34
680010	28
680011	28
680014	28
680100	28
680102	28
810604	36
820304	36
820704	36
821046	40
821048	40
821049	40

PART NUMBER	PAGE
821050	40
823520	40
892000	23
892001	23
999952	40
999956	40
2600910	21
2600922	20
2600958	14
2600959	15
2600960	12
2600967	13
2600970	18
2600971	19
31056212	38
31056312	38
31056512	38
31056612	38
31056812	38
31056912	38
31057012	38
31057112	38
31057212	38
31057312	38
31057412	38
583001N	25
583003N	25
583004N	25
583005N	25
583006N	25
583007N	25
583008N	25
583009N	25
583010N	25

PART NUMBER	PAGE
583011N	25
583013N	25
583014N	25
583015N	25
583052N	25
583057N	25
583063N	25
673001N	25
673003N	25
673005N	25
673006N	25
673008N	25
673009N	25
673010N	25
673013N	25
673052N	25
673057N	25
677000B	34
678000B	34
678050B	35
678050MB	35
679000B	34
679001B	34
679002B	35



KONGSBERG
AUTOMOTIVE

**EUROPEAN DISTRIBUTION CENTRE
KONGSBERG RAUFOSS DISTRIBUTION SAS
54 INDUSTRIELLE DE LA HARDT,
FR-67120 MOLSHEIM, FRANCE
T: +33 (0) 3 88 47 87 47
E: CONTACT.KRD@KA-GROUP.COM**

WWW.KONGSBERGAUTOMOTIVE.COM

HEURES D'OUVERTURE:
DE 8 H À 12 H ET DE 13 H 15 À 17 H
VOUS POUVEZ JOINDRE NOTRE ÉQUIPE DU LUNDI AU VENDREDI

OPENING HOURS:
FROM 8 AM TO 12 AM AND FROM 1.15 PM TO 5 PM,
FROM MONDAY TO FRIDAY.

ÖFFNUNGSZEITEN:
UNSER TEAM IST MONTAGS BIS FREITAGS
VON 8:00 UHR BIS 12:00 UHR UND VON 13:15 BIS 17:00 UHR FÜR SIE DA.